



DADO

TIMELESS LUXURY

ENDURING QUALITY

INSTALLATION GUIDE

FREESTANDING PILLAR BASINS



www.dado.co.za

ADHERE TO ALL LOCAL BUILDING AND PLUMBING CODES. THE DIAGRAMS IN THIS GUIDE ARE NOT CONSTRUCTION PLANS; THEY ARE VISUAL AIDS.



DADO

TIMELESS LUXURY

ENDURING QUALITY



DADO INSTALLATION GUIDE

Thank you for choosing DADO quality products. We recommend that you carefully read this guide to ensure your bathroom ware's proper installation and reliability for many years to come.

CONTENTS	Page
DADOquartz, our unique material	2
Installation	3
Freestanding Pillar Basin	4
Cleaning & Maintenance	5
Warranty	6

Please ensure that your plumbing system is adequate and that you have sufficient space to complete the installation.

We recommend that you employ a suitably qualified professional to complete the installation of your new DADO product. We can not accept responsibility for poor or incorrect installation. Please keep these instructions in a safe place for future reference.



DADO

TIMELESS LUXURY

ENDURING QUALITY



DADOquartz

All DADO bathtubs and basins are made from our unique material, DADOquartz. DADOquartz is an engineered stone made from resin, quartz and other natural minerals, giving our products exceptional hardness and distinguishing longevity backed by our 25-year warranty.

FEATURES & BENEFITS



EXCEPTIONALLY STRONG

Full-bodied, solid structure. Engineered & tested in accordance with stringent technical criteria.



CLEAN & HYGIENIC

Non-porous material ensures an easy to clean surface that is also resistant to micro-organisms and bacterial growth.



PREFECTLY CRAFTED

The void-free structure is free of hairline cracks, resistant to scratching, stains and abrasion.



WARM TO THE TOUCH

Due to its high heat retention properties, your bathtub will heat up quickly and remain warm.



EXTRA CARE

Hand finished to ensure a smooth, luxurious finish.



NATURAL BEAUTY

Natural matte stone appearance and satin finish. Also available in gloss finish.



PACKAGING

Packed in eco-friendly wooden crates and sealed for protection.



QUALITY ASSURANCE

25 year warranty on defects in materials or craftsmanship.



DADO

TIMELESS LUXURY

ENDURING QUALITY



INSTALLATION

Before Installation

- We recommend that the installation be done by a minimum of 2 people as a safety precaution. Also make sure to adopt the correct posture when lifting the bath or basin.
- Adhere to all local building and plumbing codes.
- The diagrams in this guide are not construction plans. They are visual aids.
- For best results, the floor must be level and the wall must be square with the floor.

Installation Requirements

Please read the instructions carefully and follow the specified guidelines so as to avoid any damage to the fixture.

1. The owner/user of the product must keep this information for future reference.
2. Consult local building codes to make sure the installation complies with standards.
3. Remove the unit from its packaging. Before disposing of it, inspect the unit to make sure it is in good shape. Should inspection reveal any damage or defect in the finish, contact your distributor. The warranty does not cover damages or defects in the finish once it has been installed. DADO's responsibility for shipping damages ceases upon delivery of the product in good order to the carrier. All complaints regarding damage due to transport must be made.
4. Place the unit in the bathroom before you start working. Conserve all nuts and bolts.
5. To protect the unit during installation, we recommend that you lay a piece of cardboard on the bottom.
6. If the unit is covered with polyethylene protective film, do not remove until installation is complete to grant maximum protection. However, remove the film where any two surfaces will be in permanent contact.
7. Verify that all dimensions on the plan are the same as the ones of the unit.

DADO pursues a policy of continual development and improvement and as such, product specifications may be changed without prior notice. All dimensions listed herein are only intended as a guide. Cast products are subject to size variants of +/- 5%

Installation Notes

IMPORTANT! Install this product according to the installation guide. Our products must be installed by certified professional only and according to our installation guide as well as federal, provincial/state and local building codes and regulations.

Technical Support Assistance

If further assistance is required, please contact:

Product Support at +27 12 803 9431 (08:00 - 17:00 GMT) or email support@dadoafrica.co.za

www.dado.co.za

ADHERE TO ALL LOCAL BUILDING AND PLUMBING CODES. THE DIAGRAMS IN THIS GUIDE ARE NOT CONSTRUCTION PLANS; THEY ARE VISUAL AIDS.



DADO

TIMELESS LUXURY

ENDURING QUALITY



INSTALLATION: FREESTANDING BASIN

Installation Instructions

1. Place pedestal into installed position. Ensure product is level when placed and mounting holes are located at the sides. Face access panel to the back.
2. Place mounting hardware provided at the base of the basin. Place a metal washer onto the bolts.
3. Mark points on the floor according to the bolt screws on the basin.
4. Drill pilot holes in the floor mounting at the marked points.
5. Fill the drilled holes in the floor with a silicon or Epoxy.
6. Place basin in the holes and clean excess silicon.
7. Let set for 24hrs.

⚠ WARNING: DO NOT OVERTIGHTEN. Overtightening may damage the products and cause personal injury and/or property damage.

Tools

- 1 person
difficulty 3/10
- Silicone
- spirit level
- marking pencil
- Safety glasses
- Drill
- Gloves
- Masonry drill
- Measuring tape

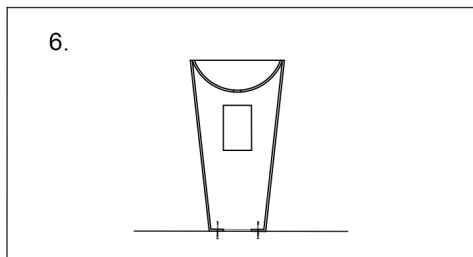
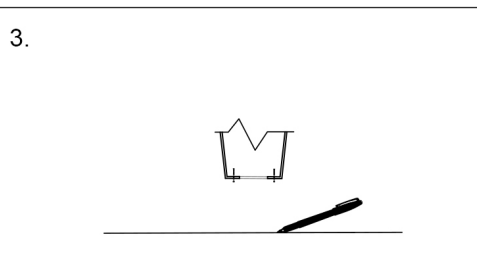
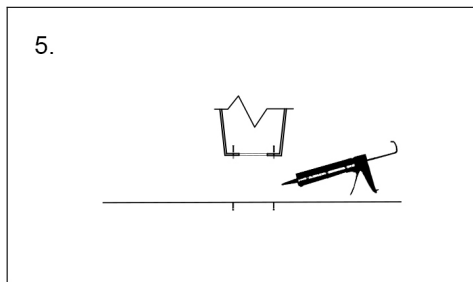
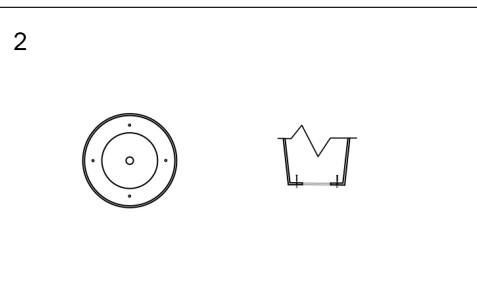
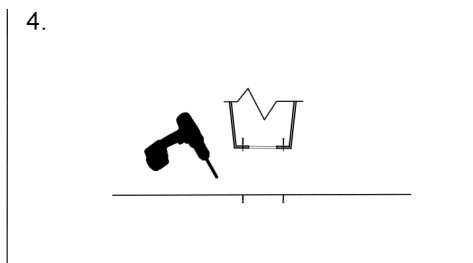
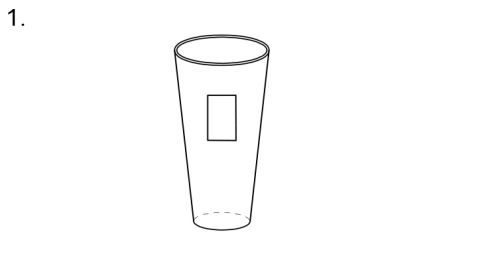

All dimensions based on recommended 10mm gap between finished wall - actual distance based on spot length to be confirmed at installation.



DADO

TIMELESS LUXURY

ENDURING QUALITY



CLEANING & MAINTENANCE

To ensure you can enjoy your DADO product for many years, we recommend you follow the maintenance and cleaning instructions below.

Routine Care

- Never expose DADOquartz to petroleum-based products, such as paint removers, oven cleaners or other solvents (personal hygiene products and cosmetics will not damage the surface)
- We recommend that stains are removed within 24 hours
- Do not directly cut on the DADOquartz surface

Standard Cleaning

For standard cleaning of both gloss, matt and custom colour finishes, we recommend using widely available cleaning products like Chemico and using a soft cloth. Matt finished products may occasionally require a mildly abrasive product. Do not use highly abrasive products.

DADOquartz matt finish

- Ensure there is no surface dirt by flushing with water
- Rub the 600-grit sanding block, provide, in a gentle circular motion
- For scratched or damaged surfaces we recommend using a higher grit sandpaper to blend the repaired area to match the existing product finish

Custom colour finish

- Ensure there is no surface dirt by flushing with water
- Do not use polish directly on the colour finish or rub with a sanding block
- We highly recommend using Chemico, a trusted DADO cleaning product, to clean stains on the coloured surface

DADOquartz gloss finish

- Ensure there is no surface dirt by flushing with water
- For scratched or damaged surfaces we recommend sanding the area starting with 1200-grit sandpaper. Do not over sand.
- Finish by polishing the surface using a cloth and white polishing compound for automobiles

Repairs

For more extensive repairs, send a photograph of your DADOquartz product to our Customer Service Department (support@dadoafrica.co.za), who will inform you as to the most appropriate methods to use.

www.dado.co.za

ADHERE TO ALL LOCAL BUILDING AND PLUMBING CODES. THE DIAGRAMS IN THIS GUIDE ARE NOT CONSTRUCTION PLANS; THEY ARE VISUAL AIDS.



DADO

TIMELESS LUXURY

ENDURING QUALITY



LIFETIME WARRANTY

Limited Warranty

DADO Manufacturing warranty on DADOquartz products covers all defects in materials and manufacturing for a period 25 years.

This limited warranty, starting on the original purchase date, is only offered to the original purchaser who acquires the product directly from DADO Manufacturing or from an authorized distributor.

This limited warranty does not apply to cases in which the product was incorrectly installed, nor to damage due to negligence, misuse, thermal shocks, cigarettes, flames, natural catastrophes or other accidents.

This limited warranty does not extend to products purchased over the internet from non-authorized DADOquartz distributors.

This limited warranty does not extend to products purchased from non-authorized DADOquartz distributors or sub-distributors or sub-dealers.

DADO Manufacturing is not responsible for costs and claims that may arise from purchase of a product ensued to the structure of the existing building.

Any transformation or alteration made to a DADOquartz product automatically voids the warranty. . Colour finishes will not be covered under this warranty. The colour finish is painted on the outside of the DADO bathtubs and basins, should the product be damaged or chipped then the natural pearl white matt finish will be visible. Damaged products can be treated at an additional cost.

The manufacturer's warranty is limited to repair or replacement (with a product of equal value), provided the claim is made to an authorized dealer or directly to DADO Manufacturing within the warranty period. Labour costs and other expenses entailed by replacement of a DADOquartz product are not covered by the warranty.

We strongly recommend that you register your DADO product on our website under Warranty Registration.

CONTACT US

Email: support@dadoafrica.co.za | **Website:** www.dado.co.za | **Telephone:** +27 12 803 9431

Address: Unit 5, Jurg Business Park, c/o Jurg and Jakaranda street, Centurion, South Africa

www.dado.co.za

ADHERE TO ALL LOCAL BUILDING AND PLUMBING CODES. THE DIAGRAMS IN THIS GUIDE ARE NOT CONSTRUCTION PLANS; THEY ARE VISUAL AIDS.